

BELVOIR!

Property is personal



£229,995

Fleetwind Drive

Northampton, NN4 0SU

PROPERTY SUMMARY

Belvoir Estate Agents are delighted to offer for sale this two bedroom semi detached house in East Hunsbury. The accommodation briefly comprises entrance hall, lounge, kitchen/diner, first floor landing, two bedrooms and a bathroom. The property further benefits from majority upvc double glazing, gas radiator heating, driveway and rear garden. There is no onward chain.

2



1



1









Fleetwind Drive, NN4

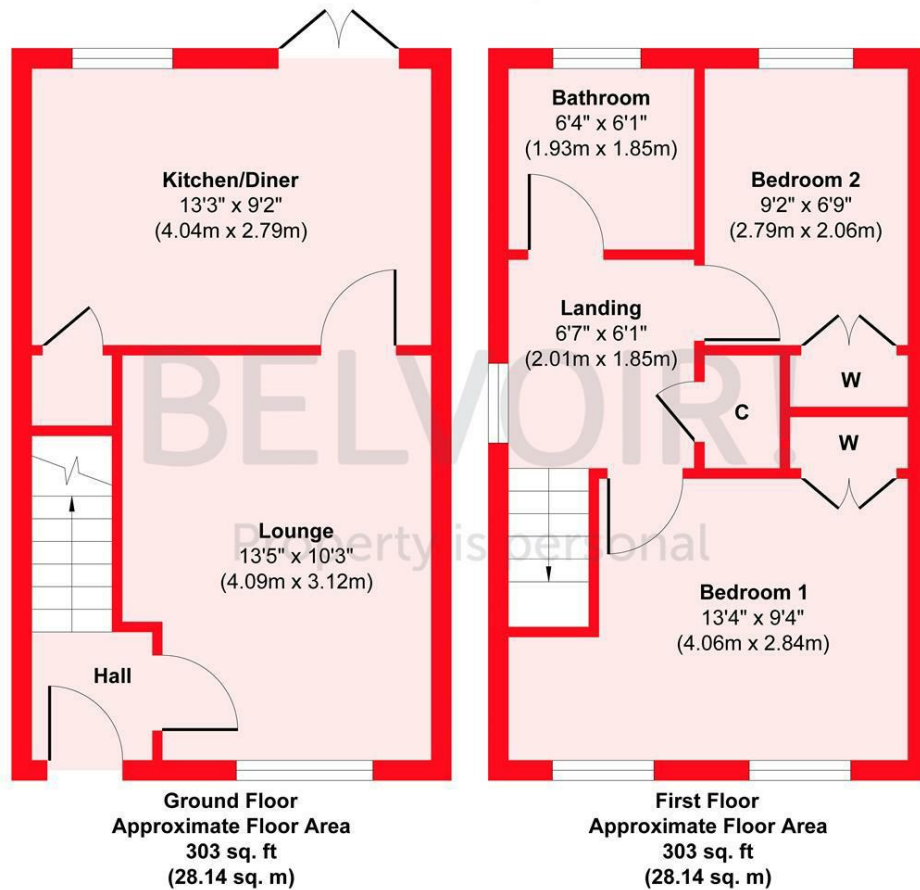

Approx. Gross Internal Floor Area 606 sq. ft / 56.28 sq. m

Illustration for identification purposes only, measurements are approximate, not to scale.
Produced by Elements Property

LOCAL AUTHORITY

Northampton

TENURE

Freehold

COUNCIL TAX BAND

B

VIEWINGS

By prior appointment only

Energy Efficiency Rating		Current	Potential
<i>Very energy efficient - lower running costs</i>			
(92 plus) A			82
(81-91) B			
(69-80) C			
(55-68) D		68	
(39-54) E			
(21-38) F			
(1-20) G			
<i>Not energy efficient - higher running costs</i>			
England & Wales		EU Directive 2002/91/EC	

Agents Note: Whilst every care has been taken to prepare these particulars, they are for guidance purposes only. All measurements are approximate and are for general guidance purposes only and whilst every care has been taken to ensure their accuracy, they should not be relied upon and potential buyers/tenants are advised to recheck the measurements

BELVOIR!

Property is personal

OFFICE ADDRESS

East Hunsbury Local Centre Butts
Road
Northampton
Northamptonshire
NN4 0UE

OFFICE DETAILS

01604 701701
northampton@belvoir.co.uk
www.belvoirnorthampton.com